

Measuring Guide

Roman Blinds

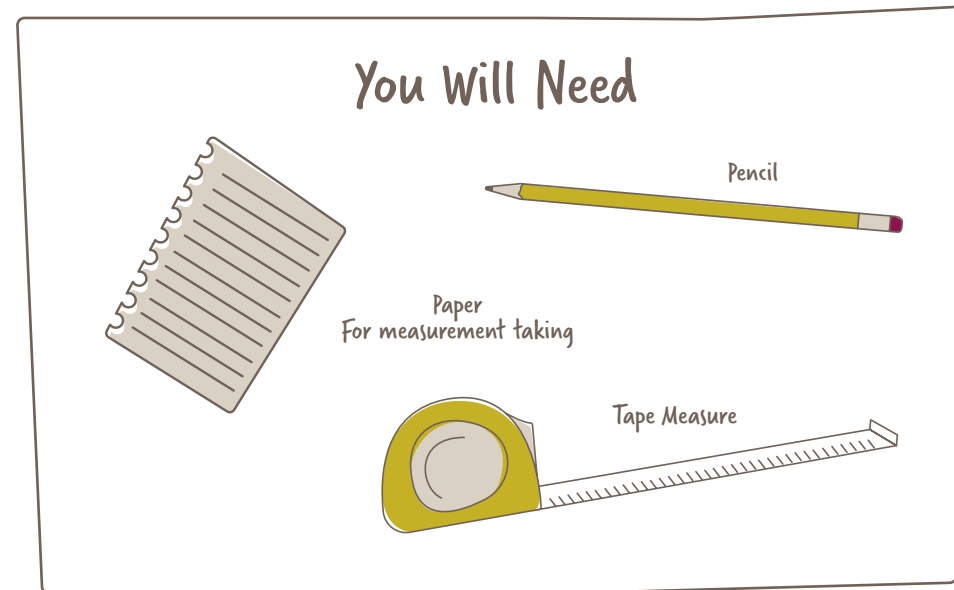

There are 2 options when it comes to deciding where you want your roman blind to sit in front of a window.

outside Recess:

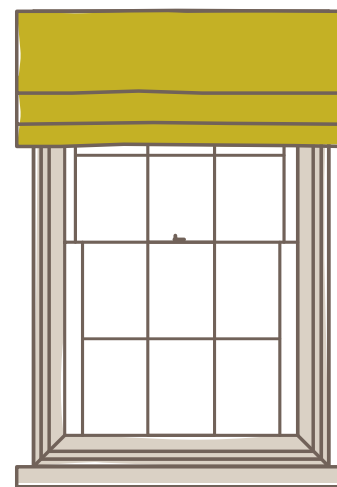

Inside Recess:

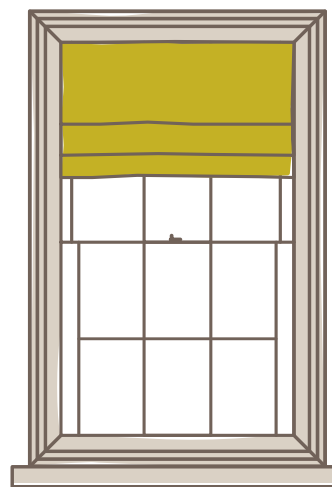

For Inside Recess Blinds:

1. Using a metal tape measure, measure at three points within the recess (top, middle and bottom) from wall to wall.
2. Subtract 1.5cm from the narrowest width of the three width measurements taken in step one. This will be the width measurement you supply to us.
3. To measure the drop, measure at three points (left hand side, middle and right hand side) between the wall and the window sill. You only need to give us the shortest drop measurement taken. There is no need to subtract anything.
4. Then, simply decide which side you would like the chain to hang.
5. Lastly, we'd like to know your installation height. This is the height from the floor to the top of the window and helps us determine how long to make your chain so you don't have to reach up too high to work your blind!

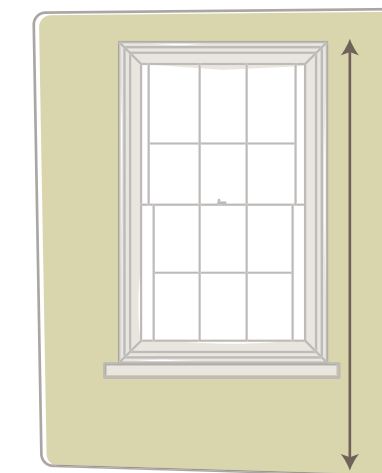
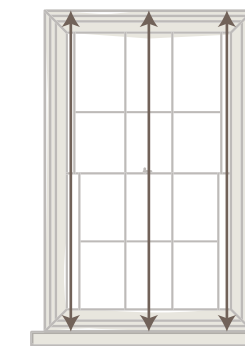
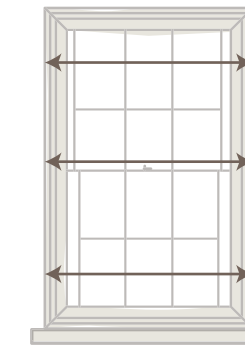

For outside Recess Blinds:

1. Firstly, measure the width of the frame using a metal tape measure.
2. Then, measure your sill width.
3. We recommend adding 10cm to the frame width (5cm each side) for our Boeboes outside recess blinds to restrict light bleed, but you can choose to go only as wide as the sill width if you prefer. Once you have decided on your preferred width, submit this measurement to us!
4. For the drop, measure between the top of the frame to the bottom of the sill. We'd suggest adding 10cm above and 5cm below to the blind drop to ensure your blind covers your window well, although you are welcome to go as high or low with the drop as you like.
5. Then, simply decide which side you would like the chain to hang.
6. Lastly, we'd like to know your installation height. This is the height from the floor to the top of the window and helps us determine how long to make your chain so you don't have to reach up too high to work your blind!

